

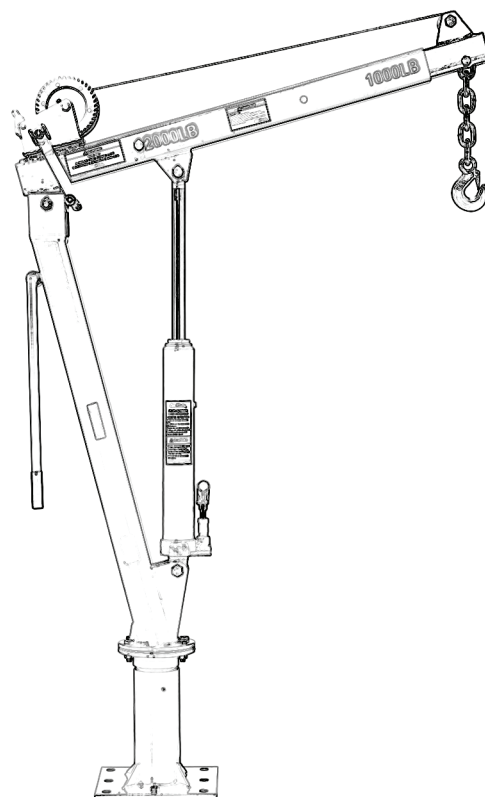

PWPHW Series

User's Manual / Manual de usuario
Safety Warnings / Advertencias de seguridad



This page intentionally left blank

PROPERTY REGISTRY № 189487
ANY REPRODUCTION IS FORBIDDEN
PROPERTY OF PROWINCH® 2025 - V09.25 ALL RIGHTS RESERVED
PROWINCH LLC COMPANY WITH QUALITY MANAGEMENT SYSTEM

PROWINCH® DISCLAIMER

To view our full warranty policy, please visit www.prowinch.com/resource-center or scan the QR code below



Thank you for purchasing our Prowinch® Hydraulic crane. This User Manual provides important information for personnel involved with the installation, operation, and maintenance of this product. Read this User Manual before installing, operating, or maintaining the product.

1. SAFETY PRECAUTIONS

The Prowinch® Hydraulic crane is designed for a safe and reliable service if operated according to the User Manual. Respect and follow all warnings for personnel and third party safety indications. Inadequate operation may cause serious risks of injuries to personnel or damage to the equipment. Read and understand this User Manual carefully before installing and commissioning the equipment. Always keep this User Manual in an accessible place for future reference. Improperly installed, maintained, or operated cranes can be the cause of serious accidents or death. This User Manual

highlights symbols and notes for caution, warning and danger. Following these indications greatly improves the safety of the operator and personnel in the area.

The compact and lightweight structure of the PWPHW models together with their ease of use makes them a preferred crane for daily use in factories, mines, sea ports and warehouses.

Mandatory use of:



Hard Hat



Safety Glasses



Safety Gloves



Safety Shoes

1.1. Hoist Safety Precautions

**WARNING:**

This symbol indicates unsafe practices or situations which may cause damage to the property and even injuries to the personnel.

**DANGER:**

This symbol indicates a potentially dangerous situation which if not avoided may cause severe injuries or death

**DANGER**

All operators and other users who are near the steel chain or its load must wear required safety equipment: gloves, safety helmet / hard hat, safety shoes and eye protection.

1.2. Before using the Equipment:

- Read and understand the instructions in this user manual and all the labels associated with the crane before operating the equipment.
- Wear appropriate clothing: Do not wear jewelry or loose clothes as they can get caught in moving parts.
- Wear sturdy leather gloves.
- Wear non-slip safety shoes, a hard hat, and eye protection.
- Perform a full check of the crane. Check for damaged parts or unusual conditions.
- Secure the hydraulic crane to a suitable surface that is capable of withstanding the load being lifted with the crane.
- Visually inspect the hydraulic crane and winch before each use in addition to the regular inspections and maintenance.

1.3. During Operation:

ALWAYS:

- Refer to the maximum load capacity displayed on the ID plate attached to the crane, not the capacity of the hook.
- Stop operation immediately if unauthorized personnel enter the working area.
- Check the working condition of crane before operation.
- Stop, check, and secure the load if the crane stops or loses movement during operation.
- Focus on the operation. Pay attention at all times and keep the load properly balanced.

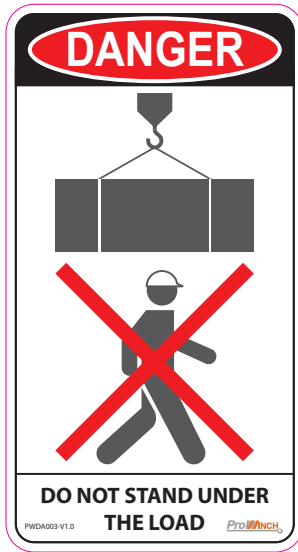

NEVER:

- Never exceed the maximum load capacity of the crane.
- Never operate a damaged or malfunctioning crane.
- Never operate the crane if it shows abnormal behavior.
- Never lift, support, or transport people or loads over people.
- Never walk or step on the wire rope.
- Never operate the hydraulic crane with twisted, kinked, damaged, or worn wire rope or chain.
- Never use the wire rope as a sling around load.
- Never operate a crane if the ID plate or safety labels are missing or illegible.
- Never operate a hydraulic crane if exposed to rain or water.
- Never use if operator is sick or not completely attentive.
- Never leave the crane unattended with a suspended load.
- Never operate the crane with non-centered load.
- Never operate beyond the limits of the wire rope or chain.
- Never use the crane or hook as an electrical or welding ground.
- Never remove the labels placed on the hydraulic crane.
- Never use the crane to lift load at an angle, nor pull or drag load.

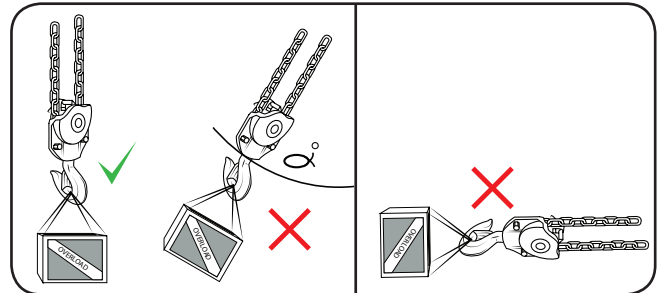

1.4. Inspection, Maintenance and Repairs:

- Only trained and authorized personnel may perform repairs on the equipment.
- Use only original ProWinch® parts. The use of any other part immediately voids the warranty.
- Failure to use only original ProWinch® parts may create dangerous conditions for the operator.

ALWAYS:

- Prevent others from stepping under lifted load.
- Inspect and maintain the crane regularly.
- Verify the correct installation of crane before using.
- Avoid contact with explosive gases or materials.

NEVER:

- **Never** overload the crane.
- **Never** transport people or animals with the crane.
- **Never** stand under suspended load.
- **Never** use the crane if exposed to rain, snow, or lightning
- **Never** leave loads suspended for an extended period of time. This may cause component deformation and accidents.
- **Never** exceed the allowable operating temperatures stated in this User Manual (differs depending on the model).
- **Never** expose the crane to water, sand, corrosive materials or other substances which may damage the equipment.

3. INSTALLATION

3.1 Unpacking

Cranes should be carefully inspected upon delivery for any damage that may have occurred during shipment or handling. Check the crane frame for: dents or cracks, wire rope for damaged or cuts, and load chain for nicks and gouges.

Check and document crane characteristics:

- a. Model number
- b. Rated capacity (tonnage)
- c. Lifting length of load chain (meter)

1. Select a flat horizontal surface to install the base (fig. 1). The base must be flat, level, and capable of withstanding any load lifted with the crane.
2. Install and secure the base to the chosen surface with 4 bolts.
3. Attach the mast to the base with bolts, as shown in fig. 2. After securing the mast, attach the boom to the mast, making sure to not overtighten it.
4. Attach the hydraulic jack to the mast and boom and raise the boom until it is parallel to the ground (fig. 2).
5. Attach the manual winch to the boom and feed the wire rope through the pulley as shown in fig. 4.

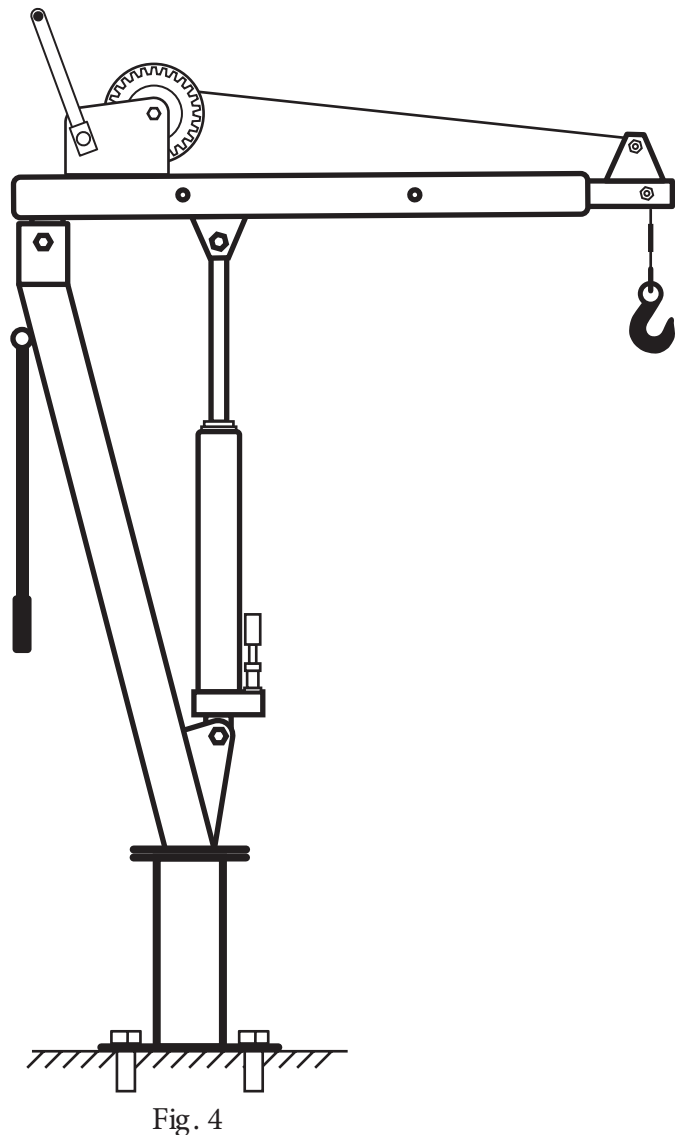
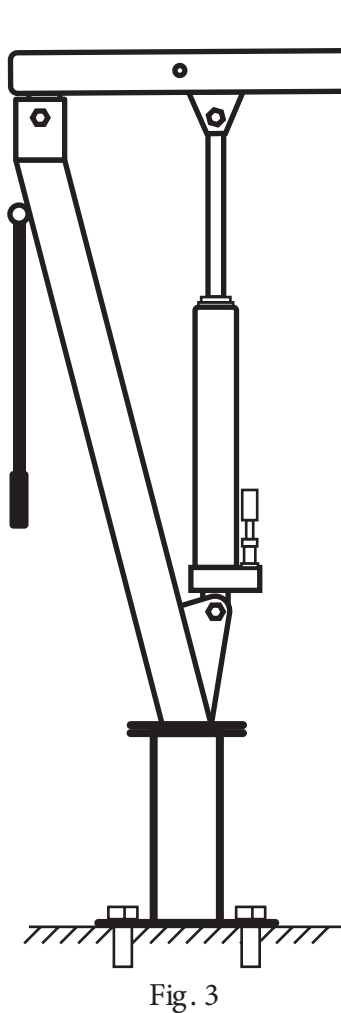
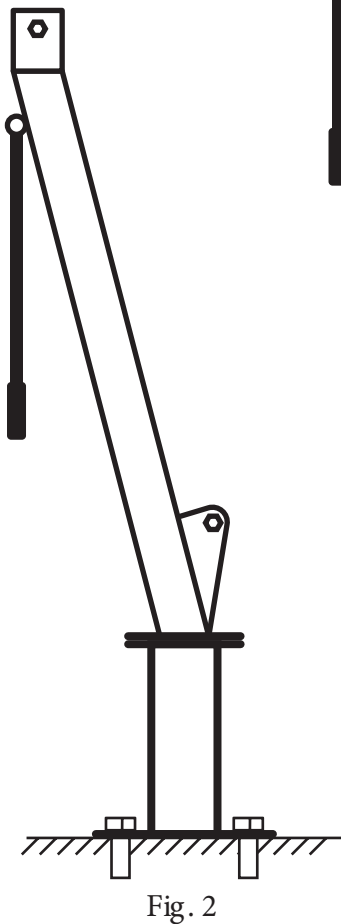
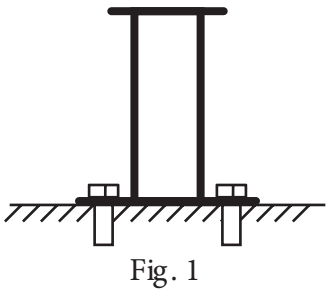

4. OPERATION

4.1. Qualified Operator

Crane operators are required to read and fully understand the operation section of this manual, all warnings contained in the manual, and labels attached to the equipment.

Operator training must be provided to ensure proper operation of equipment in compliance with instructions provided by the equipment manufacturer and the provisions of ASME B30, and proper rigging procedures for the attachment of loads to the crane.

Safe and efficient operation of the crane requires an operator who exercises caution, common sense, and good judgment in anticipating the effects of operating the crane. The operator must be fully alert, focused, and aware of the surroundings at all times.

The job must be strictly carried out under the good practices defined by the applicable international and national safety standards, such as ANSI, OSHA and ASME.

This crane must not be operated by individuals who:

- Cannot read, understand and speak the language in which the security labels, ID Plate and User Manual of equipment is written.
- Does not meet the legal age requirements.
- Is under the influence of alcohol, drugs, or medication.
- Has visual or hearing impediments, or below normal reaction times.
- Has a history of or experiences seizures, mental, heart, or other illnesses that could interfere with safe operation of the equipment.
- Has not been trained for the proper use of the crane.
- Has not received and read the User Manual for the exact equipment.
- Has not demonstrated qualifications through practical operation of crane.

4.2 Handling Precautions

ALWAYS:

- Keep crane in good condition and able to freely operate.
- Make smooth movements; avoid sudden changes of direction.
- Check the function of the crane without a load before operation.
- Make sure no one is beneath the load.

NEVER:

- Use pulleys or other accessories that are not specifically approved for the relevant crane model.
- Raise a load with the tip of the hook.
- Use the crane to pull or drag the load.
- Exceed the maximum capacity of the crane.

4.3 Recommended Operation



WARNING

Always carry out a complete inspection before starting the operation of the hoist.

See ASME B30.

Always let all personnel know that crane maneuvers are about to begin!

Do not allow Unauthorized Personnel to be in the lifting area.

Start with a complete revision of the structural integrity and mounting points of the crane, make sure everything is in order and no damage is visible.

This unit includes all the tools required to perform the job. Use the handle to rotate and position the crane boom directly over the load. With the use of the handle (Fig. 2), fasten the release valve to stop any loss of pressure. Start pumping to raise the arm, use the provided chain and hook to raise the load using the hydraulic pump. You may also set a boom height and use the manual winch to raise or lower the load.

To release pressure of the hydraulic cylinder just slowly rotate the release valve.

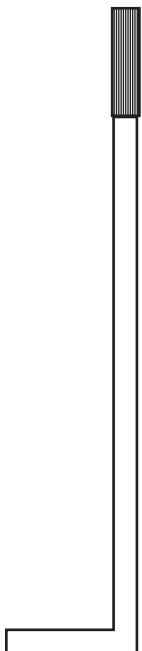

Fig. 1



Fig. 2



Fig. 3

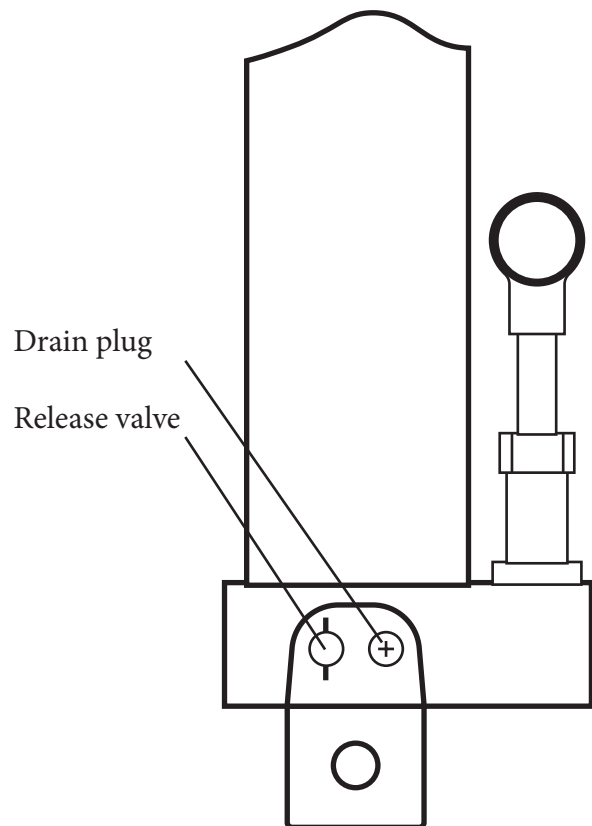

Fig. 4

Ayers USA Cranes
ayersusa.com

26111 US-90, Robertsdale,
AL 36567
251-929-1773
service@ayersusa.com

MIAMI, FL
PROWINCH LLC
www.prowinch.com

2901 NW 21st Terrace
Miami, FL 33142
United States
+1 (800) 971-8061

Fortis Alloy Mexico S.a. De C.v
Www.prowinch.mx

Fortis Alloy Mexico, S.A. de C.V. Vicente
Guerrero No. 403 Col. San Miguel,
Apodaca, Nuevo Leon,
Mexico C.P. 66649
+52 (81) 8244-1351

**Provedora Industrial
Y Tecnica, S.a. De C.v.**
Www.prointe.com.sv

Av. Alberto Masferrer Sur, Col.
Campestre No. 211
San Salvador, El Salvador
2264-1100

Guatemala

7a Avenida 1-22 Zona 13,
Pamplona, Ciudad de
Guatemala
+502 2381-8383
ever.mendez@contecindustrial.com

Lima, Peru

www.prowinch.pe

Urb. San Antonio de Carapongo.
Calle 1. Lurigancho - Lima
Phone: +51 935402797
info@prowinch.pe

Lima, Peru

www.prowinch.pe

Av Mansiche 1586, Trujillo,
La Libertad, Peru
51 44 618700
ventas@dezajacobs.com
www.dezajacobs.com

Prowinch Colombia Sas
www.prowinch.co

Cl. 163a #20-28,
Bogotá Colombia
(+57) 1 7034035

Equipos De Izaje
Prowinch Chile Spa
Www.prowinch.cl

Parque Riesco 3407, Recoleta,
Región Metropolitana, Chile
+56-2-26218989

